



H12HW Quick Reference Guide

Contents

This guide covers the following topics:

1 Before Getting Started

How to mount the EM chip and charge the battery

2 Before Use

The basics of the H12HW's keys and display

3 Using the H12HW

How to make and receive a call, and how to use the Contacts, MMS, camera, etc.

4 Connecting the H12HW with a device or machine

How to connect the H12HW with a device via Bluetooth, and how to connect the H12HW with a PC and use the phone as a data communication device

- See the Japanese User Guide for other functions and operations.

1 Before Getting Started 1. EM chip

How to handle the EM chip

The EM chip is an IC card in which your phone number and some other information are stored. Before using the H12HW, make sure that the EM chip is mounted inside the phone.

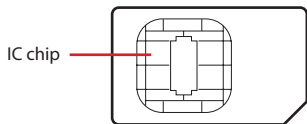

- Do not paste any labels or seals on the EM chip; otherwise, your phone may malfunction.
- Always keep the IC chip clean.
- Do not damage or short-circuit the IC chip.

Mounting the EM chip

Turn off the H12HW before mounting the EM chip. To turn the phone off, press the power key (🔴) for about two seconds.

① Remove the battery cover.

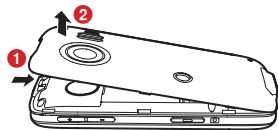

While pressing the unlock button (1), move the cover upward (2).

② Remove the battery.

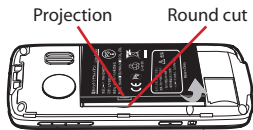

To remove the battery, move it by hand in the direction of the arrow. (The battery is easy to remove at the point where there are a projection and a round cut.)

③ Install the EM chip.

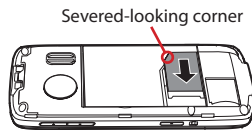

Insert the EM chip into the slot with the IC chip facing down. (Make sure that the EM chip is properly fixed.)

④ Attach the battery and battery cover.

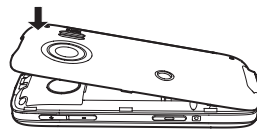

Bring the battery back to the phone. Next, fit the cover's lower part onto the phone and push its upper part in the direction of the arrow until the entire cover clicks shut.

1 Before Getting Started 2. Battery Charging

Use the provided AC adapter to charge your battery.

- The battery level is low at the time of purchase. Make sure to charge the battery before use.

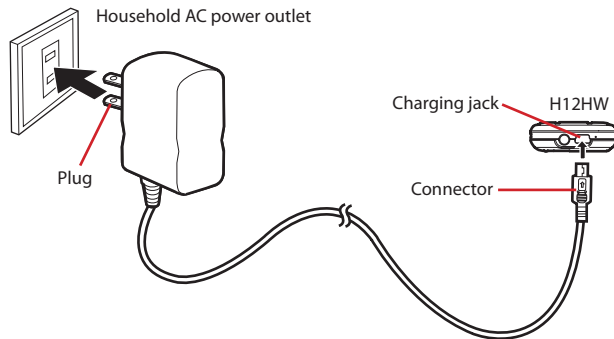

① Insert the adapter connector into the charging jack of the phone.

- Face the arrow of the connector upward.

② Insert the adapter plug into a household AC power outlet.

- Charging starts. The charging indicator (the icon that shows the flow of the bars) appears when you start charging the battery with the phone on. When the battery becomes fully charged, the charging indicator shows full charge (▣▣▣▣).

③ After the battery is done charging, unplug the adapter and pull the connector out of the phone.

- The adapter is suitable for 100-240 volt AC power.
- The adapter plug can only be used in Japan.

2 Before Use 1. Basic Operations

The most basic operations are as follows:

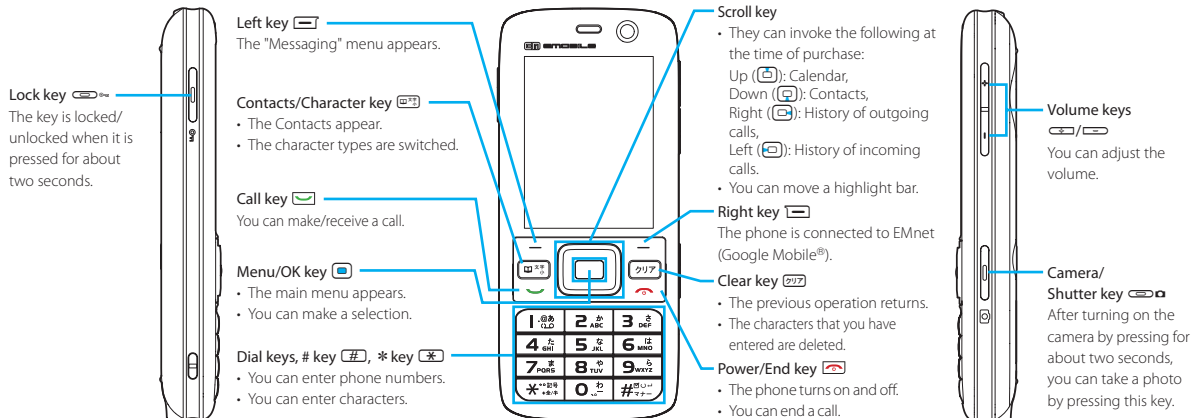

● There are some simplified key images in this guide.

<Example> Phone : → Quick reference guide :

Auto Keypad Lock

The H12HW has a function called the "Auto Keypad Lock" that automatically locks the keys when the phone remains unused for a certain period of time. The Auto Keypad Lock prevents the keys from being accidentally pressed while you are carrying the phone in a bag. The icon appears on the standby display while the Auto Keypad Lock is operating.

Follow the steps below to activate or deactivate the function.

- 1 Show the standby display, and press → .
- 2 Using the scroll and OK keys (), select "Phone settings" → "Keypad lock period".
- 3 Using the scroll and OK keys (), select a keypad lock period.

There are three keypad lock periods: "5s" (5 seconds), "15s" (15 seconds) and "30s" (30 seconds). Select "Off" to deactivate the Auto Keypad Lock.

2 Before Use 2. Basic Display <Standby Display>

This indicates how strong the signal strength is.

When there is no reception, "No Service" appears on the standby display and no communication service is available. Use the phone in a location where you can get good reception.

This indicates that the phone is inside the service area.

This indicates that Bluetooth is working.

This indicates that the phone is being connected to the Internet.

This indicates that a call is being made/received, or that you are on the line.

This indicates that the alarm has been set.

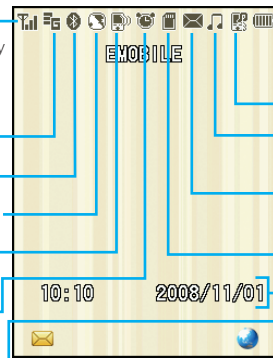

This indicates how much battery power is left in the battery. Charge the battery immediately after you see the icon  blinking; otherwise, the battery will be flat soon.

This indicates that the phone can ring.

This indicates what mode the phone is in. In some modes, the phone does not ring, or it beeps when being operated.

This indicates that there is at least one unread MMS/SMS message.

This indicates that a microSD card has been inserted.

This indicates the current time and date.

This indicates operation guidance.

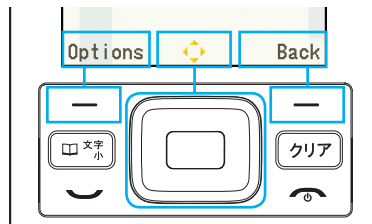

This indicates an example of operation guidance which shows what the three keys are for.

2 Before Use 3. Basic Display <Main Menu>

The icons on the H12HW's main menu are used to invoke several functions.

The main menu appears with a press on  (OK key) when the standby display is shown.

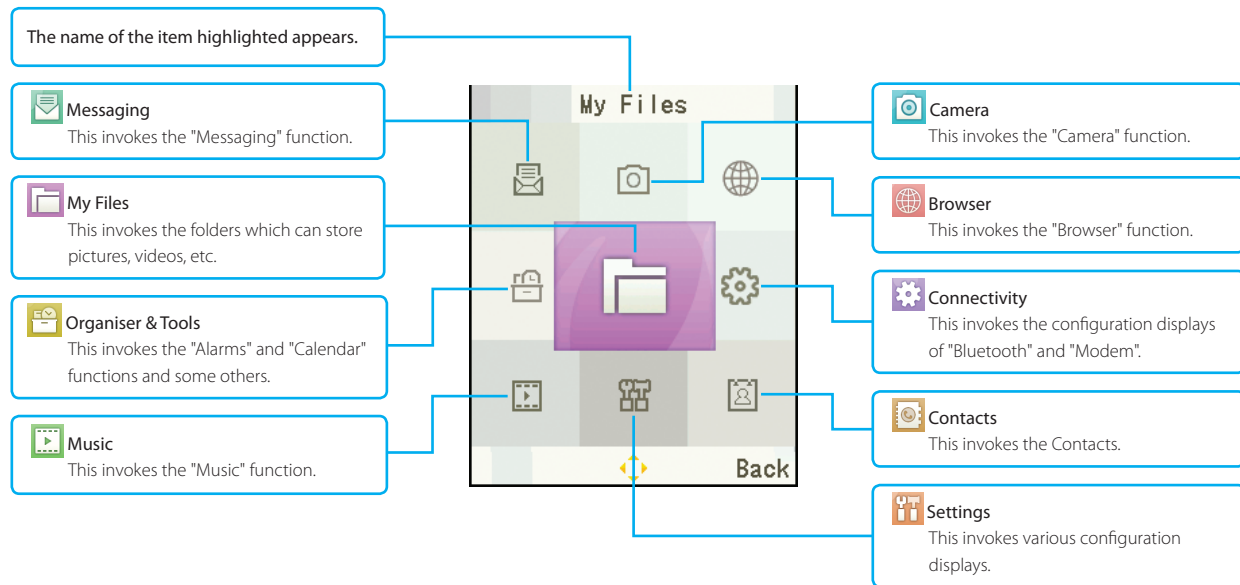

■ To display your phone number

Show the standby display, and press  → .

3 Using the H12HW 1. Making and Receiving a Call

Relevant Keys

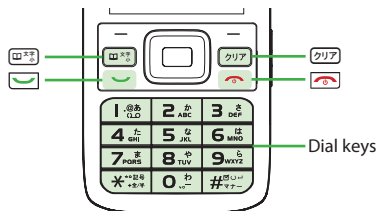

Making a call

1 Enter a phone number with the dial keys.

- Press **[☎]** to delete a phone number that you have entered.



2 Press **[☎]**.

The recipient's phone rings. A call starts when it is received.

- Press **[☎]** to make a TV call.

3 Press **[☎]** to hang up.

The line is disconnected.

Receiving a call

When you receive a call, the phone starts to ring and a notification display appears.

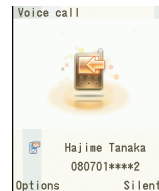

1 Press **[☎]**.

A call starts after you answer the phone.

2 Press **[☎]** to hang up.

The line is disconnected.

3 Using the H12HW 2. Using the Contacts

Relevant Keys

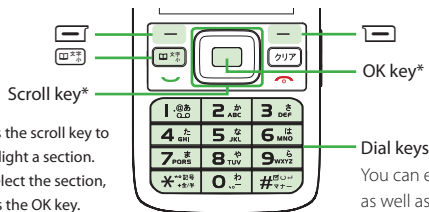

*: Press the scroll key to highlight a section. To select the section, press the OK key.

Dial keys
You can enter numbers as well as different types of characters.

Creating a new contact

- 1 Show the standby display, and press . The Contacts appear.



- 2 Press (Options), and select "New".

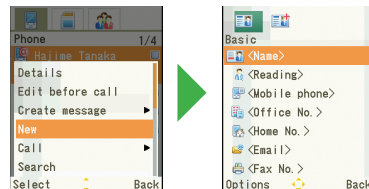

- 3 Select the fields that you want to fill in, and fill them in (You do not need to fill in all the fields).
 - You cannot make a phone call to the person at the fax number (<Fax No.>).
- 4 Press (Options) and select "Save". The contact is created.

Making a call using a contact

You can use some functions using a contact. One of them is making a call. The steps are as follows:

- 1 Show the standby display, and press . The Contacts appear.
- 2 Highlight the section that you want to use, and press . A call starts.

3 Using the H12HW 3. Sending an MMS Message/Viewing an Unread MMS Message

Relevant Keys

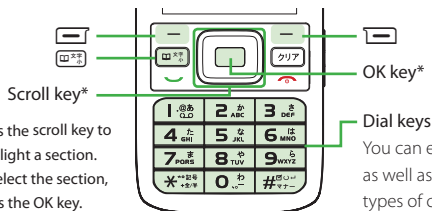

*: Press the scroll key to highlight a section. To select the section, press the OK key.

Dial keys
You can enter numbers as well as different types of characters.

Sending an MMS message

- 1 Show the standby display, press , and then select "Write MMS".

The "Edit MMS" display appears.

■ The "Edit MMS" display returns after you finish filling in each field.

- 2 Select "<To>", press (Options), and then select "Edit".

■ After selecting "Contact", you can select a recipient from the Contacts.

- 3 Enter an address, and press (OK) → (Back).



- 4 Select "<Subject>", enter a title, and press .
- 5 Select "<Content>" → the icon .

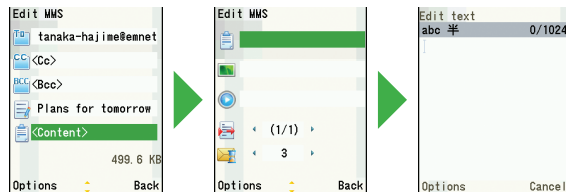

- 6 Fill in the text field, and press → (Back).
- 7 Press (Options) and select "Send".
The MMS message is sent.

Viewing an unread MMS message

When an MMS message arrives, the phone rings and a notification message appears.



- 1 After a notification message appears, press (View), and then select an unread MMS message.

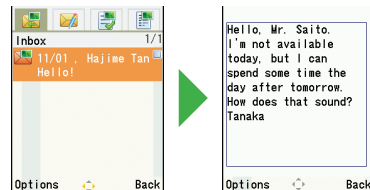

3 Using the H12HW 4. Using the Camera/Listening to Music

Relevant Keys

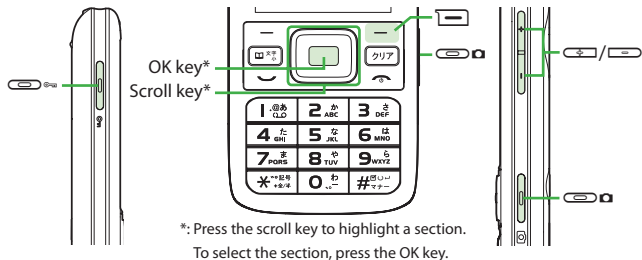

Camera lenses

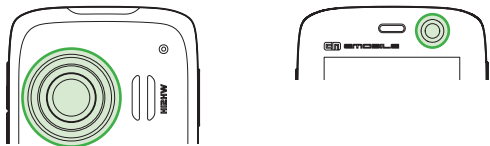

Camera shooting

- 1 Show the standby display, and press for about two seconds.

The camera turns on, and the shooting display appears.



- 2 Press .

A still image is shot and automatically stored.

- Press (Back) to continue.
- Press to switch the still image mode into the moving image mode.

Listening to music

- 1 Select (Music) on the main menu → "My music".

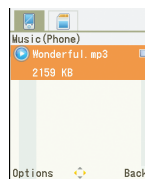
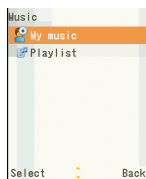
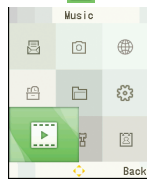

- 2 Select a file.

The file plays.

- Press to stop playing.
- Press to adjust the volume.
- Pressing (Mini.) enables background playback, during which other functions can be used. When the standby display is on the screen during background playback, pressing for about two seconds turns the volume off, and pressing brings the playing display back.
- The provided headset delivers stereo sound.



④ Connecting the H12HW with a device or machine 1. Bluetooth

You can send and receive data by wirelessly connecting the phone with a Bluetooth-enabled device.

- See "Bluetooth" (p.10-2) in the Japanese User Guide for further information in Japanese about the Bluetooth connection.

Bluetooth activation

- 1 Select  (Connectivity) on the main menu → "Bluetooth".

The "Bluetooth settings" display appears.

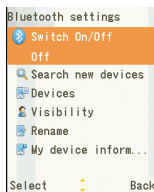

- 2 Select "Switch On/Off" → "On".



Bluetooth starts up. The icon  appears at the upper part of the screen.

Bluetooth pairing

- 1 Select "Search new devices" on the "Bluetooth settings" display.

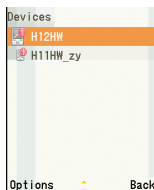
The names of the devices found appear.



- 2 Select  (Options) → "Pair".
- 3 Enter your Bluetooth passcode (4 to 16 digits), and press  (OK).

The passcode is sent to the device with which you are attempting to pair the phone. The pairing is completed when the phone receives the same passcode from the device.

- 4 Press  (No).

The pairing is completed.

Data transmission via Bluetooth

You can transmit data saved in the Contacts, photo holder, etc. to another Bluetooth-enabled device.

<Example>To transmit data saved in the Contacts

- 1 Highlight the section in which the data that you are attempting to transmit. Next, select  (Options) → "Via Bluetooth".

The names of the paired Bluetooth devices appear.

- 2 Select  (Options) → "Send".

The transmission is completed.

- How to transmit data varies depending on the type of data.

See "データを送受信する" (p.10-6) in the Japanese User Guide for further information in Japanese about the types of data that you can transmit.

④ Connecting the H12HW with a device or machine 2. PC

There are several things that you can do by operating a PC after connecting it with the H12HW; for example, connecting the phone into the Internet and sending/receiving MMS messages.

- Install two types of software into the PC in advance: one for connection with the phone and the other for dial-up access. For further information in Japanese about installation, see "USB接続" (p.10-8) and "ダイヤルアップでインターネットに接続する" (p.10-13) in the Japanese User Guide.

Connecting the H12HW with a PC

Use the provided USB cable to connect the phone with your PC. After installation, the "EMOBILE PC Assistant" window appears on the PC screen. The English "EMOBILE PC Assistant" window appears if your PC has an English operating system in it.

- You can also use Bluetooth for the connection.

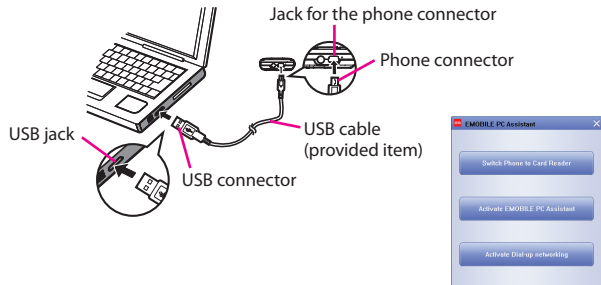

Communication

Follow the steps below to use the USB cable to connect the phone with your PC.

- 1 Select (Connectivity) on the main menu → "Modem".
- 2 Select "Modem via USB".
- 3 Use the USB cable to connect the phone with the PC.
- 4 Click "Activate Dial-up networking", which is in the "EMOBILE PC Assistant" window displayed on the PC screen.
- 5 Select the connection setting icon (1) and click the dial-up icon (2).

Communication starts.

